



Loxwood Parish Council

email: Clerk@loxwood-pc.gov.uk

www.loxwood-pc.gov.uk

Loxwood Neighbourhood Plan Call for Sites Information Template

*Loxwood Parish Council Neighbourhood Plan Steering Group is preparing a revision to the existing Neighbourhood Plan and wishes to identify potential additional housing sites alongside those already identified in the Plan. If you have land available for development, the Steering Group would like to hear from you. Please download and complete this template and return it by post or email to: Jane Bromley, Clerk, Loxwood Parish Council, Foxways, Pinkhurst Lane, Slinfold, Horsham. RH13 0QR. Clerk@loxwood-pc.gov.uk
Sites put forward will be subject to a site assessment procedure to ascertain suitability.
This template should be returned by the 17th January 2020*

Site name: The Wharf (plus land as the back of), High Street

Site address: The Wharf, High Street, Loxwood, RH14 0RE

Ownership(s): Mr K and Mrs M Overington

Site Proposer and relationship to owner:

Alison Guyton of Henry Adams, 50 Carfax, Horsham, RH12 1BP

alison.guyton@henryadams.co.uk 01403 282511

Land agent acting for landowners

Is the site under an option agreement? No

Site Plan: Provide a separate site and location plan at 1:1200 and 1:25000 scales respectively and include a red line around the boundary of the site: Plans for title WSX167030 and WSX167031 attached

Site area in hectares: 1.75



Loxwood Parish Council

email: Clerk@loxwood-pc.gov.uk

www.loxwood-pc.gov.uk

Proposed number of houses: 18-22

When is the site available for development: 3-5 Years
(could be sooner if required for housing demand)?

Are there any barriers to delivery of the site e.g. legal issues, contamination, covenants, public footpaths within the site, demolition of existing buildings, overhead power lines etc:

- Overhead cables to south west corner
- Existing residential dwelling to be demolished
- Canal borders southern boundary so proposal would be to develop top half of the site and have wildlife planted area to the south to protect the view from existing nearby houses and the canal, and protect wildlife along canal (see attached supplementary plan for more details wildlife area)

Any special circumstances to promote use of site for housing:

Adjoins currently allocated site of Land South of Loxwood Farm Place (HLX0007 under CDC HELAA)

Would have little impact on the street scene from the High Street whilst providing additional family homes with pleasant outlooks

HM Land Registry
Official copy of
title plan

Title number **WSX167030**
Ordnance Survey map reference **TQ0331SE**
Scale **1:1250 enlarged from 1:2500**
Administrative area **West Sussex :**
Chichester



© Crown copyright and database rights 2019 Ordnance Survey 100026316. You are not permitted to copy, sub-license, distribute or sell any of this data to third parties in any form.

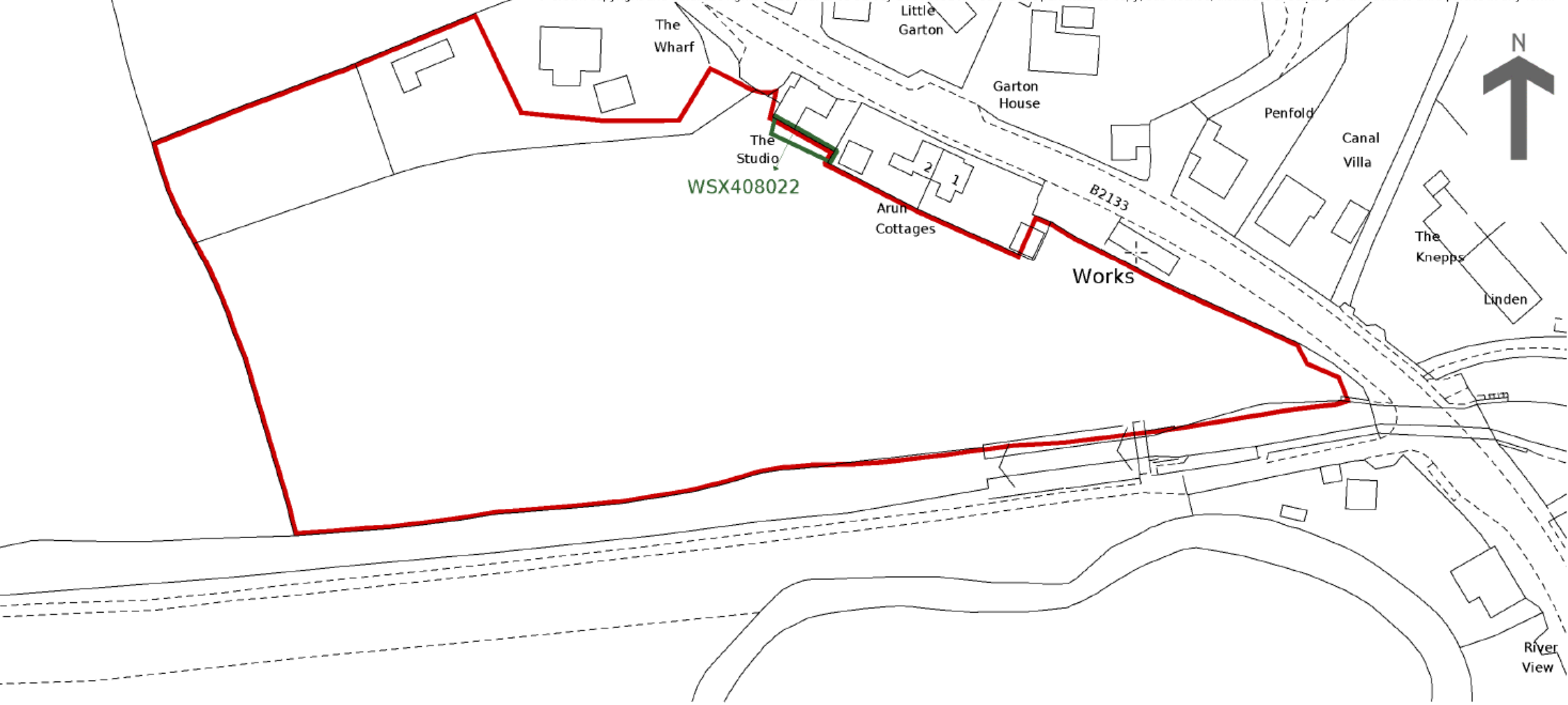

H.M. LAND REGISTRY		TITLE NUMBER	
		WSX 167031	
ORDNANCE SURVEY PLAN REFERENCE	TQ 0331	SECTION A	Scale 1/1250 Enlarged from 1/2500
	COUNTY WEST SUSSEX		DISTRICT CHICHESTER
LOXWOOD PARISH			

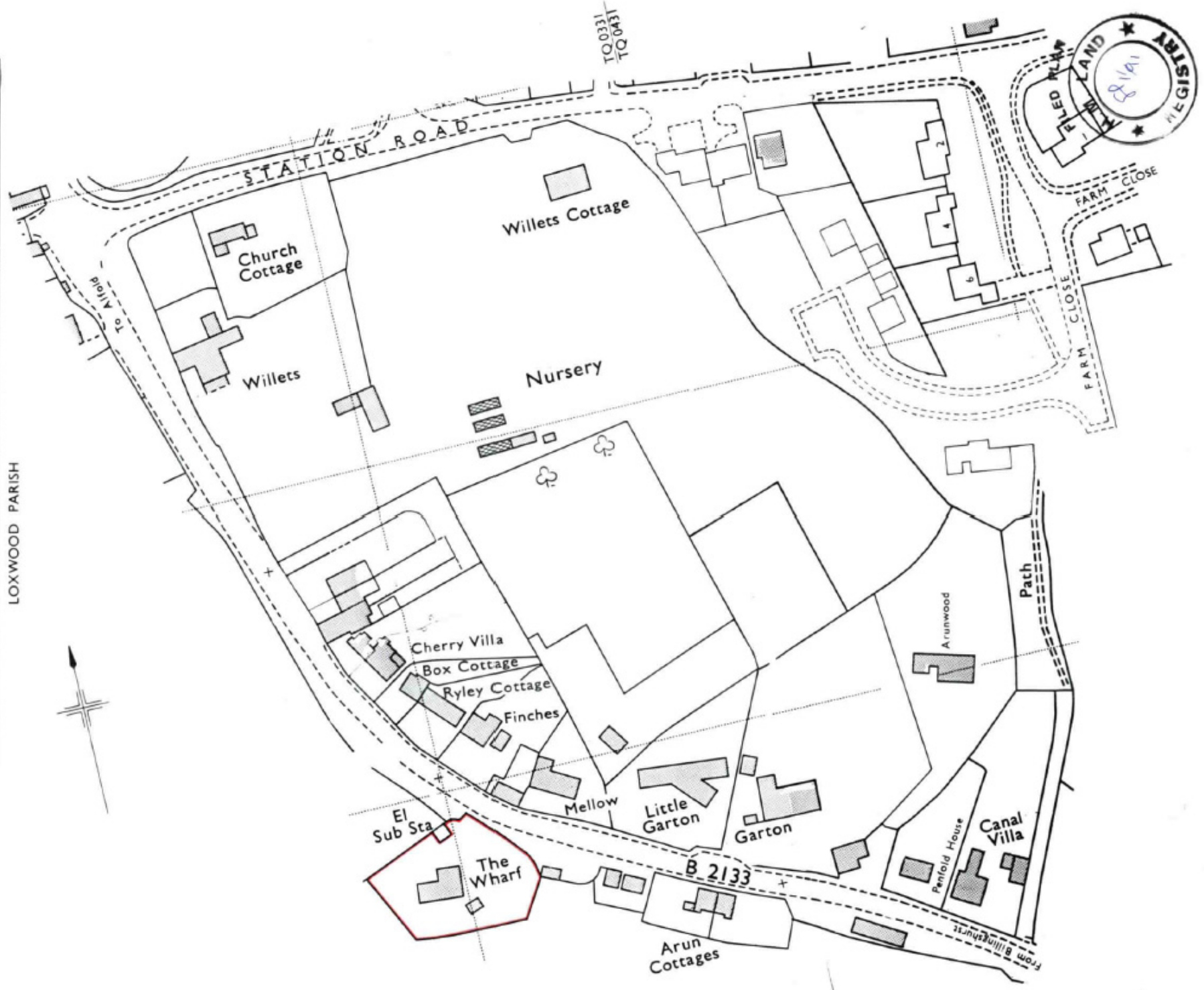

The Wharf, High Street, Loxwood

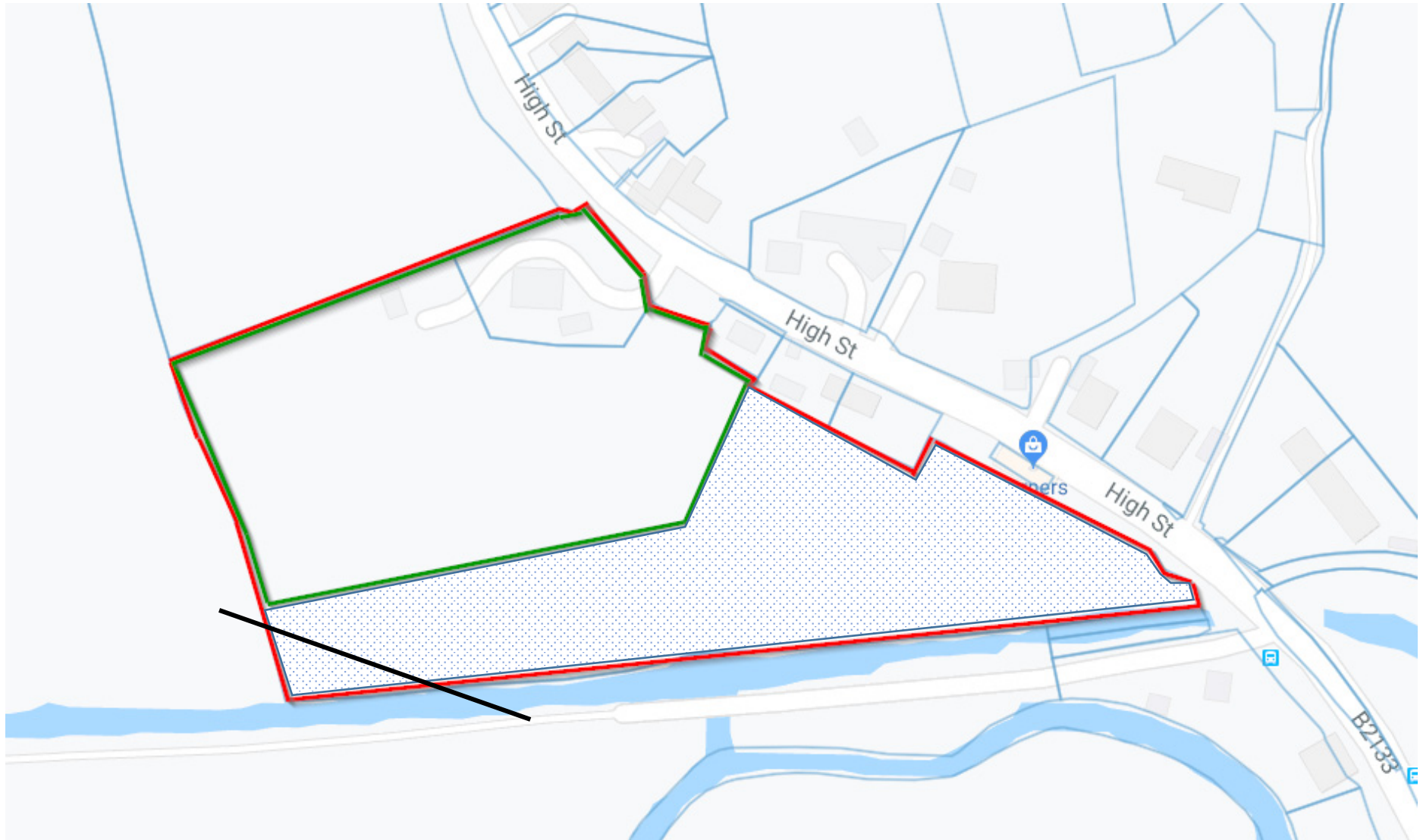

- Outline of land parcels (1.75h)
- Outline of proposed location of new dwellings (18-22)
- Overhead cable position (approx.)
- ▨ Area of proposed wildlife planted area